



WE HELP YOU SELL YOUR FOOD ONLINE

# Hardware Requirements

## Minimum requirements for your order-taking tablet/smartphone

- charging while on
- good wi-fi signal (if you want to connect through a wi-fi hotspot)
- loud speaker
- android version 4.4 or later (with Google Play supported)
- at least 1gb of RAM memory

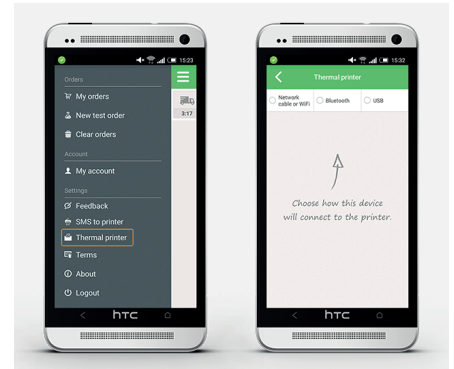

As a rule of thumb any tablet with a price over £60.00 would do the job. A Samsung Galaxy Tab A 7 Inch 8GB Tablet is a good example.

**Don't buy Kindle Fire....** it does not have the Google Play marketplace and push services so it won't work.

**Warning: Generally cheap Android tablets are optimised to save battery causing connectivity problems. It is very important to get top of the line Android tablets (Samsung Galaxy S-line, Lenovo Yoga line, Huawei M line, Google Pixel C); otherwise get an Apple tablet even if it's one or two versions older than an Android tablet.**

## Printing off orders

You will probably have several sources of orders; walk-in, telephone and online. You can input all your orders from these channels into your existing POS system. As most POS systems have a printer connected to them you can use the same workflow for all of your orders.

It is possible to directly print from the order-taking device (smartphone / tablet) to a thermal printer connected via USB cable, Bluetooth or Wi-Fi. In the case of a Wi-Fi printer this will work as long as both the order-taking device and the thermal printer are connected to the same network via a WiFi modem or a network cable that is wired to the printer.

## RECOMMENDED LAN printers for easy installation and optimal connectivity:

1. EPSON TM-T20 with Ethernet interface
2. EPSON TM-T20II with Ethernet interface
3. EPSON TM-T70II with Ethernet interface
4. EPSON TM-T82 with Ethernet interface
5. EPSON TM-T82II with Ethernet interface
6. EPSON TM-T88V with Ethernet interface
7. SEIKO RP-D10 with Ethernet interface
8. SEIKO RP-E10 with Ethernet interface
9. SEIKO RP-E11 with Ethernet interface
10. STAR TSP100LAN with Ethernet interface
11. STAR TSP650II with Ethernet interface
12. STAR TSP700II with Ethernet interface
13. STAR TSP800II with Ethernet interface
14. STAR SP700 with Ethernet interface